

OVERALL SITE TRAFFIC CONTROL NOTES

1. CLOSE NORTHBOUND HAWKEYE PARK ROAD FROM MELROSE INTERSECTION TO ACCESS DRIVE NORTH OF PROJECT.
2. PLACE DETOUR SIGNAGE AS SHOWN.
3. SOUTHBOUND LANE TO REMAIN OPEN TO TRAFFIC.
4. AVOID DAMAGE TO EXISTING GROUND OUTSIDE OF ROADWAY RECONSTRUCTION AREA.

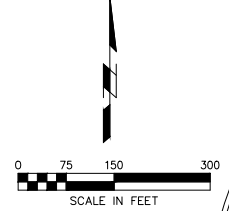
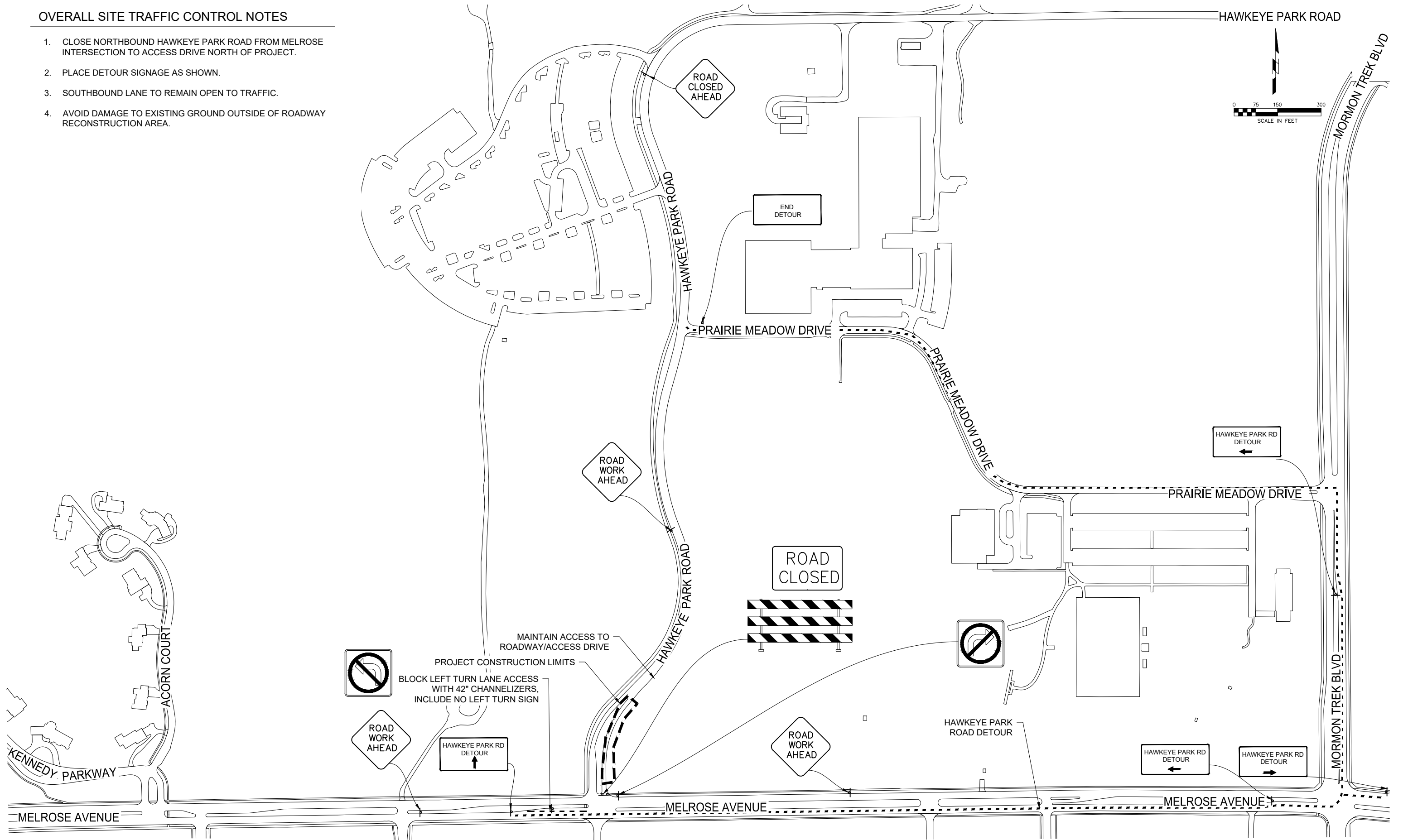

HAWKEYE PARK ROAD TRAFFIC CONTROL

1" = 300'

JANUARY 22, 2021

BID DOCUMENTS

P:\Projects\CR1206870\Deliverables\Drawings\1_Civil\J.02 - OVERALL TRAFFIC CONTROL.dwg