

P:\projects\10224\10224-0000\Drawings\10224-0000\10224-0000.dwg
Printed: 9/2/2021 3:05:25 PM

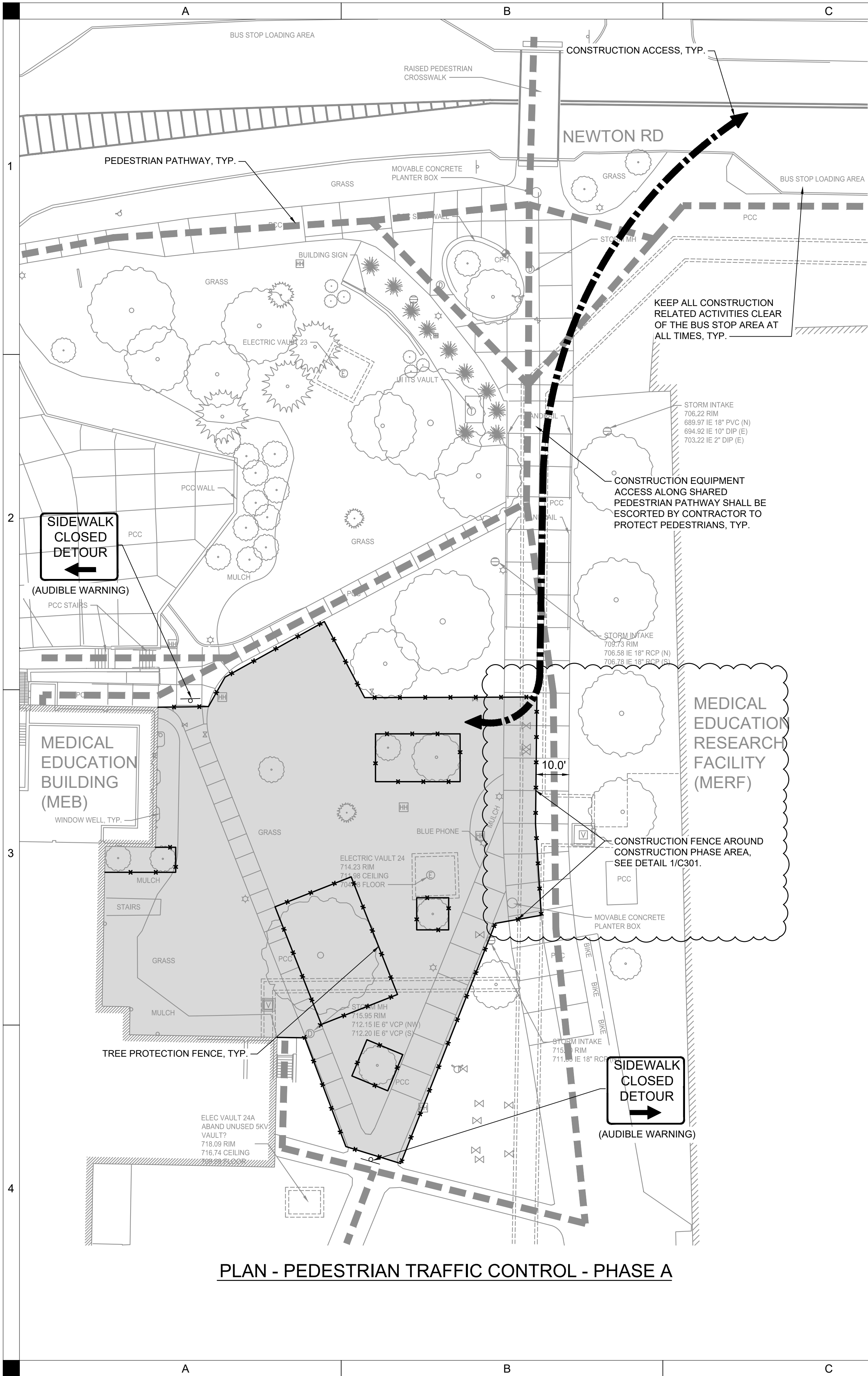

PLAN - PEDESTRIAN TRAFFIC CONTROL - PHASE A

PHASE B OMITTED DUE TO
ALLOWABLE FENCE
ADJUSTMENTS TO PHASE A.

PEDESTRIAN TRAFFIC
CONTROL NOTES

1. PHASING DRAWINGS ARE PROVIDED TO DESCRIBE THE REQUIRED SCHEDULING OF THE WORK IN THIS PROJECT TO ACCOMMODATE VEHICLE AND PEDESTRIAN ACCESS ON SITE. PHASING DRAWINGS DO NOT SHOW THE FULL EXTENT OF WORK IN EACH PHASE, BUT RATHER A GENERAL WORK AREA AND SITE ACCESS REQUIREMENTS. REFER TO OTHER DRAWINGS FOR FULL SCOPE OF WORK.
2. CONTRACTOR MAY SUBMIT ALTERNATE TRAFFIC CONTROL AND PHASING OPTIONS FOR OPERATOR APPROVAL PRIOR TO CONSTRUCTION.
3. NO CONTRACTOR VEHICLE PARKING WILL BE ALLOWED ON SIDEWALKS, DRIVES, GRASS, OR STREETS OUTSIDE OF CONSTRUCTION LIMITS. VEHICLES PARKED OUTSIDE CONSTRUCTION LIMITS WILL BE TOWED AT THE EXPENSE OF THE VEHICLE OWNER.
4. FENCING SHOWN ON THE PLANS IS A MINIMUM. CONTRACTOR IS RESPONSIBLE FOR PROVIDING FENCING TO MAINTAIN A SECURE SITE AT ALL TIMES, AND TO ACCOMMODATE ACTUAL WORK LIMITS AND PHASING LIMITS. PROVIDE CONSTRUCTION FENCE FOR ALL WORK EXTENDING BEYOND MAIN SITE FENCE.
5. CONTRACTOR SHALL REPAIR OR REPLACE DAMAGED CONSTRUCTION FENCE ON THE SAME DAY AS IT IS DAMAGED, MAINTAINING A SECURE SITE AT ALL TIMES. CONTRACTOR SHALL REPAIR OR PATCH ANY DISTURBED AREAS DUE TO FENCING INSTALLATION.
6. NO ROAD OR LANE CLOSURES PERMITTED FOR STAGING OF DELIVERY TRUCKS.
7. ALL SIGNAGE AND AUDIBLE WARNING DEVICES SHALL BE FURNISHED, ERECTED, AND MAINTAINED BY THE CONTRACTOR DURING THE PROJECT. THEY SHALL BE REMOVED AT THE END OF THE PROJECT.
8. FOR AUDIBLE WARNINGS USE THE EMPCO-LITE MODEL 400ML AUDIBLE INFORMATION DEVICE OR APPROVED EQUAL.
9. CONTRACTOR TO PROVIDE FLAGGERS TO STOP PEDESTRIAN OR VEHICULAR TRAFFIC AS CONSTRUCTION VEHICLES CROSS SIDEWALKS AND BUILDING ENTRIES TO ACCESS/EXIT THE CONSTRUCTION SITE. ESCORT CONSTRUCTION EQUIPMENT ALONG SHARED USE PEDESTRIAN PATHWAYS.