

OVERALL SITE TRAFFIC CONTROL NOTES

1. CLOSE HAWKEYE PARK ROAD FROM MELROSE INTERSECTION TO SOUTH OF PRAIRIE MEADOW DRIVE.
2. INSTALL SIDEWALK CLOSED AHEAD SIGNAGE AND SIDEWALK DETOUR SIGNAGE AT NEAREST CROSSINGS OF MELROSE AVENUE. (IF BID ALTERNATE 1 IS ACCEPTED)
3. INSTALL SIDEWALK CLOSED SIGNAGE AT LIMITS OF CONSTRUCTION SITE. (IF BID ALTERNATE 1 IS ACCEPTED)
4. AVOID DAMAGE TO HAWKEYE PARK ROAD, ADJACENT SIDEWALK AND EXISTING GROUND OUTSIDE OF ROADWAY RECONSTRUCTION AREA.
5. BID ALTERNATE 1 WORK TO BE COMPLETED IN TWO PHASES WITH A DURATION OF 2 WEEKS EACH AS SHOWN ON SHEET J.01.

BID ALTERNATE 1 HAS BEEN ACCEPTED
BID ALTERNATE 1 PHASES 1 & 2 MAY BE COMBINED

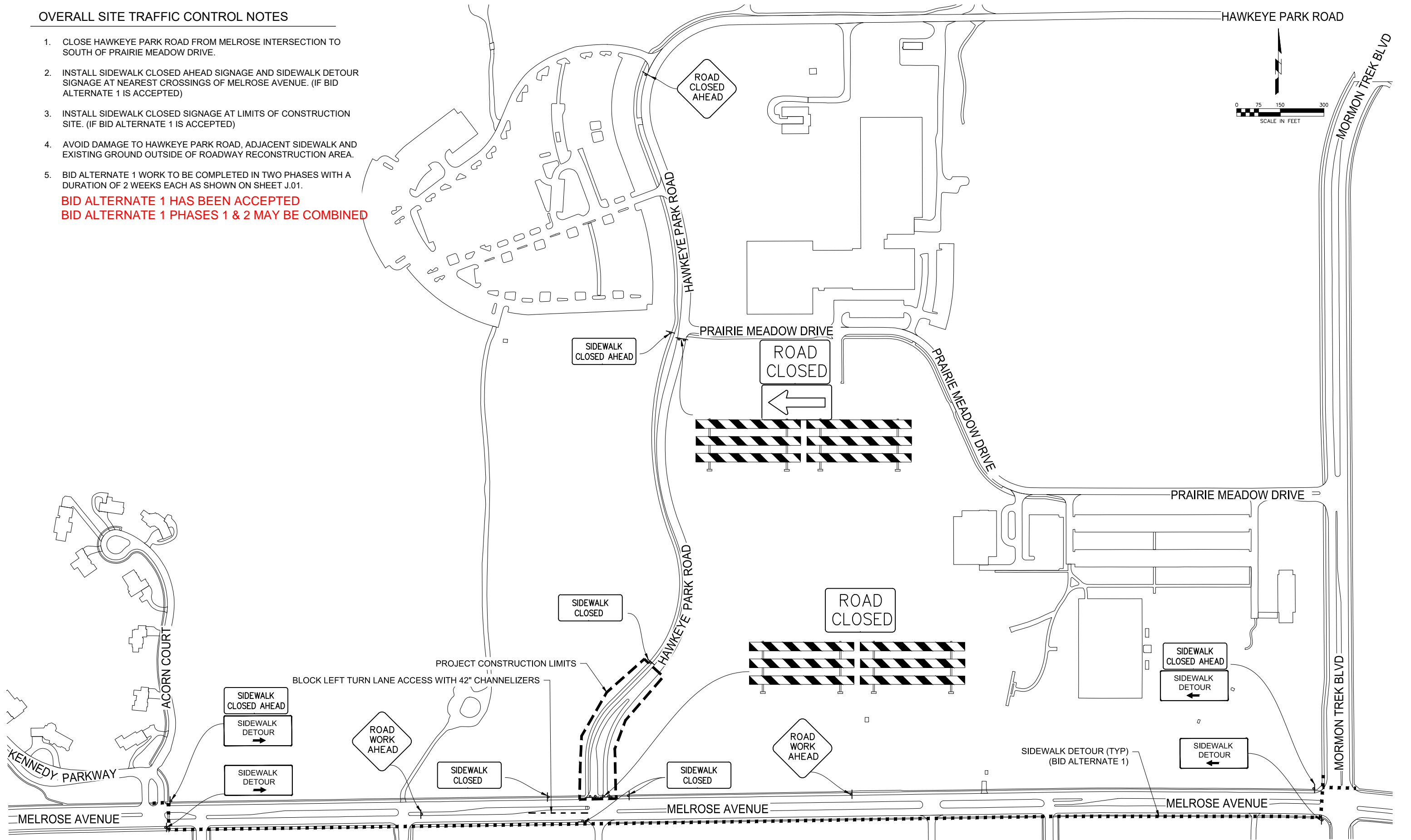

HAWKEYE PARK ROAD TRAFFIC CONTROL

1" = 300'

DECEMBER 13, 2019

BID DOCUMENTS

P:\Projects\1183090\Deliverables\Drawings\J.02 - OVERALL TRAFFIC CONTROL.dwg