







SITE PREPARATION AND DEMOLITION NOTES

- CONSTRUCTION FENCE IS REQUIRED AROUND CONSTRUCTION AREAS AND ALL UNATTENDED OPEN EXCAVATIONS. FENCE SHALL BE CONSTRUCTED AS SHOWN ON THE PLAN AND MAINTAINED IN AN UPRIGHT POSITION AT ALL TIMES. PROVIDE MOVEABLE CHAIN LINK CONSTRUCTION FENCE TO SECURE ALL WORK OUTSIDE OF THE CHAIN LINK FENCE. SEE DETAILS 1/C3.01 AND 2/C3.01.
- SITE FENCING SHALL BE MAINTAINED BY THE CONTRACTOR IN AN "AS-INSTALLED" CONDITION THROUGHOUT THE LIFE OF THE PROJECT. CONTRACTOR SHALL LEAVE THE TEMPORARY CONSTRUCTION FENCING IN PLACE TO REMAIN ON SITE AND BECOME PROPERTY OF THE OWNER AFTER FINAL COMPLETION. OWNER WILL UTILIZE SITE FENCING ON A SEPARATE PROJECT FOLLOWING THE COMPLETION OF THIS PROJECT.
- ALL CONSTRUCTION AND TREE PROTECTION FENCE SHALL BE INSTALLED BY THE CONTRACTOR AND APPROVED BY OWNER PRIOR TO START OF SITE CONSTRUCTION ACTIVITIES. NO MATERIALS OR VEHICLES MAY BE STORED OR PARKED UNDER THE DRIPLINE OF TREES. TREE PROTECTION FENCE MUST PROTECT THE ENTIRE TREE AS SHOWN ON DETAIL 3/C3.01. IT MAY BE PULLED BACK TEMPORARILY FOR WORK WITHIN THE DRIPLINE.
- CONTRACTOR SHALL USE CAUTION WHILE INSTALLING FENCE NOT TO DAMAGE UNDERGROUND UTILITIES.
- FENCING, BARRICADES AND SIGNAGE MUST BE USED TO DIVERT TRAFFIC AROUND THE CONSTRUCTION ACTIVITY.
- THE CONTRACTOR SHALL PROVIDE AND INSTALL TEMPORARY CONSTRUCTION PROJECT SIGNAGE AND MAINTAIN SIGNAGE THROUGHOUT CONSTRUCTION. SIGN MAY BE INSTALLED ON THE PROJECT FENCING OR SUPPORTED INDEPENDENTLY DEPENDING ON SITE CONDITIONS. SEE PLAN FOR SIGN LOCATION AND DETAIL 7/C3.01.
- ALL ROADWAYS AND DRIVES EXCEPT FOR THOSE INDICATED SHALL BE KEPT OPEN AT ALL TIMES. THE CONTRACTOR MUST PERFORM THE WORK IN A MANNER THAT WILL MAINTAIN UNINTERRUPTED VEHICULAR AND PEDESTRIAN TRAFFIC. CONTRACTOR TO MAINTAIN ROADS FREE OF RUTS.
- CONTRACTOR IS REQUIRED TO MAINTAIN POSITIVE DRAINAGE ON THE SITE THROUGHOUT THE DURATION OF THE PROJECT.
- CONTRACTOR SHALL INSTALL EROSION CONTROL MEASURES ON SITE PRIOR TO PERFORMING SOIL DISTURBING ACTIVITIES.
- CONTRACTOR SHALL IMMEDIATELY AND SUSPEND WORK IF SUSPECT CONTAMINATED SOIL IS ENCOUNTERED.
- DUST CONTROL: THE CONTRACTOR SHALL IMPLEMENT DUST CONTROL MEASURES WHERE DUST IS GENERATED. FREQUENT WATERING OF THE SITE, SPRINKLING/IRRIGATION, VEGETATIVE COVER, MULCH, WINDBREAKS, TILLAGE, STONE AND SPRAY-ON CHEMICAL SOIL TREATMENTS (PALLIATIVES) ARE POSSIBLE DUST CONTROL MEASURES. IF THE DUST CONTROL IS NOT ACCEPTABLE IT SHALL BE CHANGED AS DIRECTED BY THE OWNER'S REPRESENTATIVE.
- CONTACT THE OWNER'S REPRESENTATIVE TO COORDINATE ANY TREE PRUNING REQUIRED FOR WORK. ALL PRUNING OF TREES SHOWN TO REMAIN SHALL BE COMPLETED BY OWNER. THE CONTRACTOR SHALL USE CAUTION NOT TO DAMAGE TREES NOT SHOWN TO BE REMOVED.
- REMOVAL AND DISPOSAL OF EXISTING TREES AND SHRUBS WITHIN CONSTRUCTION LIMITS SHALL BE DISPOSED OF OFF SITE AND IN ACCORDANCE WITH GOVERNMENTAL REGULATIONS. STUMPS AND ROOTS ARE TO BE GROUND TO A MINIMUM TWO FEET BELOW FINISHED GRADE.
- CONTRACTOR SHALL STRIP ANY TOPSOIL ON SITE AND STOCKPILE.
- EXCESS EXCAVATED MATERIAL THAT WILL NOT BE USED ON SITE OR STOCKPILED SHALL BE DISPOSED OF OFF SITE AT LOCATION(S) SECURED BY THE CONTRACTOR.
- IN THE EVENT THAT LIGHTING CIRCUITS ARE INTERRUPTED INTENTIONALLY OR UNINTENTIONALLY THE CONTRACTOR SHALL IMMEDIATELY PROVIDE A TEMPORARY SPLICE TO REESTABLISH THE CIRCUIT. THE CONTRACTOR SHALL CONTACT THE OWNER'S REPRESENTATIVE PRIOR TO MAKING ANY PERMANENT ELECTRICAL CONNECTIONS. PERMANENT CONNECTIONS SHALL BE PROVIDED BY CONTRACTOR AT NO ADDITIONAL COST TO THE OWNER.
- EXISTING PAVEMENT SHALL BE REMOVED IN FULL PANELS OR AS NOTED ON DRAWINGS. DOUBLE SAW CUTTING SHALL BE AT THE CONTRACTOR'S DISCRETION. IF THE EDGES OF EXISTING PANELS ARE DAMAGED DURING CONSTRUCTION, THOSE PANELS SHALL BE REPLACED AT NO ADDITIONAL COST TO THE OWNER.
- IT IS THE CONTRACTOR'S RESPONSIBILITY TO DETERMINE THE ACTUAL PAVEMENT REMOVAL LIMITS AND ACCOUNT FOR THOSE IN THE BID PRICE. NO ADDITIONAL COMPENSATION WILL BE GIVEN FOR PAVEMENT REMOVAL IN ADDITION TO WHAT IS SHOWN IN THE DRAWINGS. THE LIMITS OF ROADWAY AND SIDEWALK REMOVAL SHOWN ARE A MINIMUM.
- CONTRACTOR SHALL REPLACE AT NO COST TO THE OWNER ALL DAMAGED STREET SIGNS, PAVEMENT MARKINGS, SIDEWALK LAMPS, SIDEWALKS, STEPS, LANDSCAPE STRUCTURES, CURB AND GUTTER, STREETS, DRIVES AND ALL OTHER SURFACE STRUCTURES NOT SCHEDULED TO BE REMOVED DURING THE COURSE OF THE WORK.
- WHERE A SECTION OF PAVEMENT, CURB AND GUTTER, OR SIDEWALK IS CUT OR OTHERWISE DAMAGED BY THE CONTRACTOR, THE ENTIRE SECTION SHALL BE REMOVED AND REPLACED AT NO COST TO THE OWNER. PAVEMENT, CURBS, GUTTERS, AND SIDEWALKS SHALL BE REMOVED TO THE NEAREST JOINT A MINIMUM OF TWO FEET BEYOND THE EDGE OF ALL EXCAVATIONS. CONTRACTOR SHALL DOCUMENT (OR PHOTO) ALL CRACKED PCC PAVEMENT OR DAMAGED ACC PAVEMENT PRIOR TO CONSTRUCTION. IF NEW CRACKS IN PCC PAVEMENT DEVELOP OR ACC PAVEMENT IS DAMAGED DUE TO CONSTRUCTION TRAFFIC (EXTENDS BEYOND CONSTRUCTION LIMITS), CONTRACTOR SHALL REPLACE DAMAGED AREA AT NO ADDITIONAL COST TO THE OWNER.
- ALL LANDSCAPING INCLUDING TREES, SHRUBS, BUSHES AND GRASS OR TURF NOT CALLED OUT TO BE REMOVED ON THE DRAWINGS SHALL BE REPLACED WHERE DAMAGED DURING CONSTRUCTION AT NO COST TO THE OWNER. WHERE TREES, BUSHES AND SHRUBS CANNOT BE OR ARE NOT PROTECTED, OR ARE OTHERWISE DESTROYED OR DAMAGED BY CONTRACTOR, THE TREES, BUSHES AND SHRUBS SHALL BE REPLACED WITH NEW PLANTS OF THE SAME VARIETY AND SIZE AS THE PLANT DAMAGED OR DESTROYED. WHERE GRASS OR TURF IS DESTROYED OR DAMAGED DURING CONSTRUCTION, SURFACE SHALL BE RESTORED TO THE CONDITION THAT EXISTED PRIOR TO CONSTRUCTION.
- THE CONTRACTOR SHALL TREAT THE ON SITE SOILS AND BRING IN ROCK SURFACING AS NEEDED TO MAINTAIN A SUITABLE WORKING SURFACE DURING CONSTRUCTION.
- CONTRACTOR TO EXPEDITE WORK OUTSIDE OF MAIN CONSTRUCTION FENCE AND RESTORE ACCESS TO SIDEWALKS AND BUILDING ENTRANCES AS SOON AS POSSIBLE.
- SEE SHEET C3.02 FOR UTILITY DEMOLITION PLAN.
- UI WILL PROVIDE CONTAINERS TO THE CONTRACTOR FOR DISPOSAL OF HAZARDOUS MATERIALS. SEE SPECIFICATIONS FOR ADDITIONAL INFORMATION. CONTACT JIM PYRZ (319-335-4625) TO COORDINATE.
- REFER TO SPECIFICATION SECTION 02 41 00 FOR BUILDING SALVAGE REQUIREMENTS.

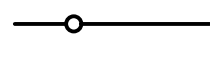
LEGEND

-  REMOVE EXISTING BUILDING AND FOUNDATIONS
-  REMOVE EXISTING PAVEMENT
-  CHAIN LINK CONSTRUCTION FENCE
SEE DETAIL 1/C3.01.
-  MOVEABLE CHAIN LINK CONSTRUCTION FENCE
AND TREE PROTECTION FENCE
SEE DETAILS 2 AND 3/C3.01.
-  REMOVE EXISTING SHRUB/TREE AND STUMP
-  REMOVE EXISTING SURFACE FEATURE

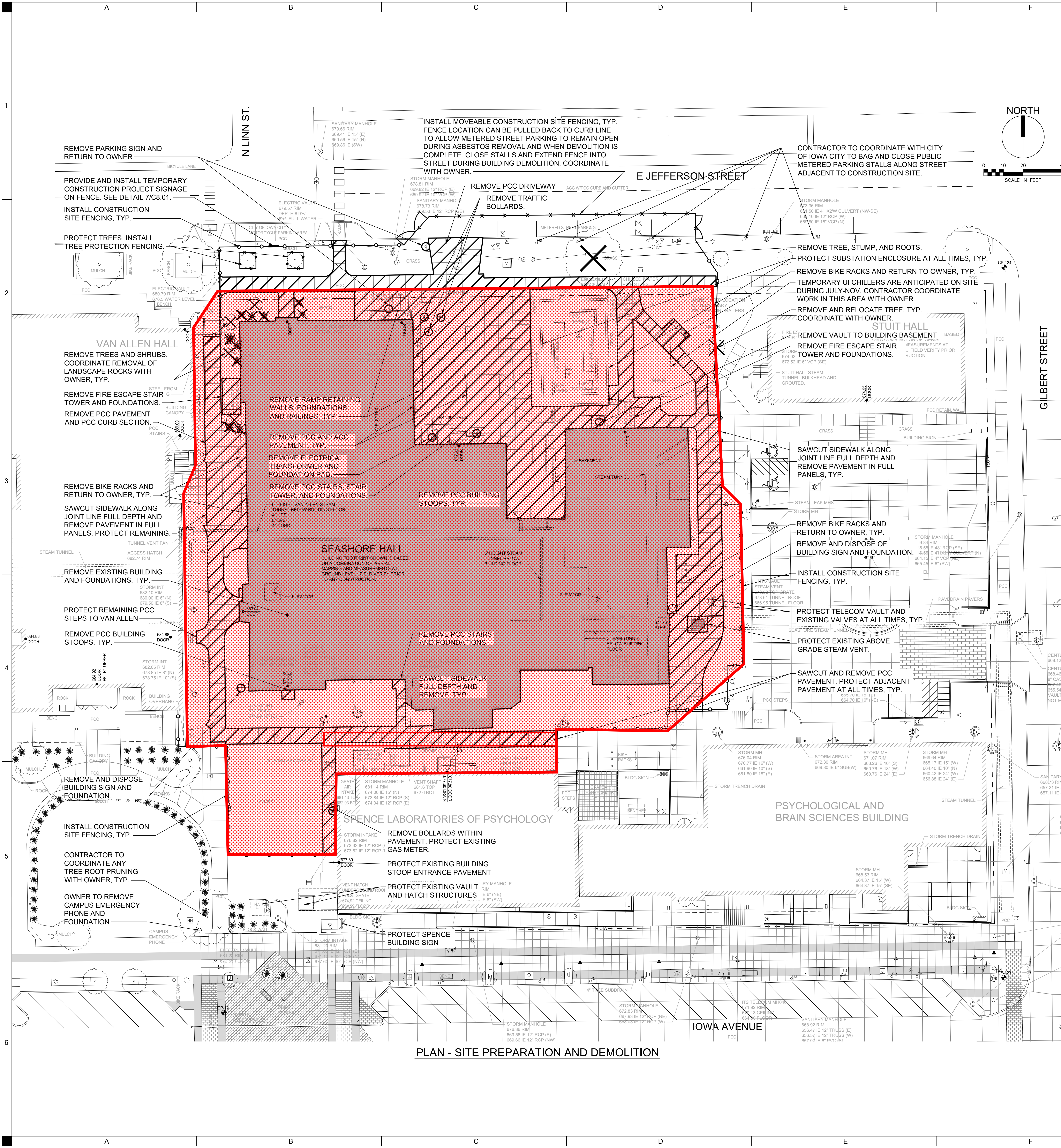

PLAN - SITE PREPARATION AND DEMOLITION

PROJECT NO: 11837-01
 SHEET NO: C3.01
 DATE: 06/11/2020
 ISSUED FOR: BID
 DRAWN: TNS
 APPROVED: TNS